

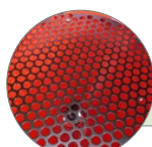

	Cod.	Mod.	Descr.
	620105	P-PL-PX	Supporto luci <i>Lights holder</i>

	Cod.	Mod.	Descr.
	620120	P-PL-PX	Kit luci completo <i>Lights kit</i>

	Cod.	Mod.	Descr.
	642010	P-PL-PX	Griglia interna <i>Hopper grid</i>

	Cod.	Mod.	Descr.
	902001	P-PL-PX 180	Telo copertura <i>Hopper cover</i>
	902002	P-PL-PX 300	Telo copertura <i>Hopper cover</i>
	902003	PL 400 P-PX 400/500	Telo copertura <i>Hopper cover</i>
	902037	PL 500	Telo copertura <i>Hopper cover</i>

	Cod.	Mod.	Descr.
	619012	PL-PX	Agitatore <i>Agitator</i>

	Cod.	Mod.	Descr.
	619004	P-PX	Agitatore <i>Agitator</i>

	Cod.	Mod.	Descr.
	618020	P-PL-PX	Kit leva lunga <i>Long levers kit</i>

	Cod.	Mod.	Descr.
	206004	P-PL-PX	Protezione disco <i>Safety shield</i>

	Cod.	Mod.	Descr.
	620106	P-PL-PX	Convogliatore 2 vie <i>2-rows lateral conveyor</i>

	Cod.	Mod.	Descr.
	620102	P-PL-PX	Convogliatore 1 fila <i>1-row lateral conveyor</i>

OPTIONAL P/PL/PX



Cod.	Mod.	Descr.
620101	P-PL-PX	Limitatore standard <i>Standard deflector</i>
620122	P-PL-PX	Limitatore Inox <i>Stainless steel deflector</i>

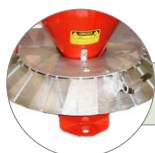

Cod.	Mod.	Descr.
620100	P-PL-PX	Limitatore Inox professionale <i>Professional Stainless steel limiter</i>



Cod.	Mod.	Descr.
619111	P-PL-PX	Apertura idraulica doppio effetto <i>Hydraulic opening</i>

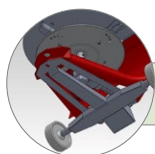

Cod.	Mod.	Descr.
613301	P-PL-PX	Kit carrello <i>2 wheels kit</i>



Cod.	Mod.	Descr.
619130	P-PL-PX	Porta targa in acciaio <i>Plate holder in st. steel</i>



Cod.	Mod.	Descr.
---	P-PL-PX	Versione equipaggiata con motore idraulico <i>Hydraulic engine</i>



Cod.	Mod.	Descr.
610046	P-PL-PX	Costo addizionale per 6 palette e disco inox <i>Additional cost for 6 stainless steel fins and stainless steel disc</i>